

# How to View Your Property Information on Record

LancasterCountyPA.gov/154/Property-Assessment

There are two places to find a link to search records on the main Property Assessment website (shown below)  
**-OR-** navigate directly to: LancasterPa.devnetwedge.com

Home » Government » All Offices & Departments  
» M - Z » Property Assessment

Espanol

## Property Assessment



The Lancaster County Property Assessment Office assesses real estate within the county for the local property tax levy, County government, 17 school districts, and most of the 60 municipalities in the county levy a property tax. For most, the property tax is their principal source of revenue. The Assessment Office maintains a listing

lanastercountypa.gov

← Mobile is one continuous column with all of the same information

↓ Desktop is three columns

2027 Reassessment Information

Yearly Appeals & Pricing Information

Meeting Minutes and Agenda

Clean & Green Program

County Sales Data

Homestead / Farmstead

Home » Government » All Offices & Departments » M - Z » Property Assessment

Espanol

## Property Assessment

The Lancaster County Property Assessment Office assesses real estate within the county for the local property tax levy, County government, 17 school districts, and most of the 60 municipalities in the county levy a property tax. For most, the property tax is their principal source of revenue. The Assessment Office maintains a listing



### Contact Us

Kevin Edwards, CPE

Director of Assessment

Email

150 N. Queen St.

Suite 310

Click on either of these links to access the property record search:

There is a link for current data & a link for reassessment data

### Center column on desktop

TO VIEW YOUR PROPERTY INFORMATION

[View Property Assessment Records](#)

[How to use the Property Search Site](#)

[View 2027 Reassessment Property Records](#)

### Left column on desktop

#### Quick Links

- [Property Assessment Address Change Form](#)  
use to update mailing address
- [2027 Reassessment Record Information \(wEdge\)](#)  
view reassessment records (2027)
- [Assessment Record Information \(wEdge\)](#)  
view assessment records (2026)
- [LOI \(Letter of Information\)](#)
- [Manufactured Homes LOI](#)
- [Land Use Codes](#)
- [Assessment Data Request Form](#)
- [LanCo View \(GIS Maps\)](#)

### Pop - Up

Leaving Site

**You Are Now Leaving Our Website**

Links from the County's website to other sites on the Internet do not constitute an endorsement or recommendation by the County. The County is not responsible for the content, quality, or accuracy of any off-site materials referenced or linked through the County's website, the user acknowledges and accepts that the County is not responsible for any materials stored on other Internet sites, nor is it liable for any inaccurate, defamatory, offensive, or illegal materials found on other Internet sites, and that the risk of injury from viewing, hearing, downloading, or storing such materials rests entirely with the user. The County does not exercise any editorial control over the information you may find at these external locations, and disclaims any and all liability for and knowledge of their contents.

Thank you for visiting and please come again.  
Please wait to be directed to the selected URL in 252 seconds...

Click **Proceed to Site** to open search

Lancaster County 

Basic Search | Advanced Search



**Parcel Number (Account Number)**

Parcel Number (Account Number)

Lancaster County presents the information on this web site as a service to the public. We have tried to ensure that the information contained in this electronic document is accurate. Lancaster County makes no warranty or guarantee concerning the accuracy or reliability of the content at this site or any other sites to which we link. Determining the accuracy and reliability of this information is the responsibility of the user. Lancaster County shall not be liable for errors contained herein or for any damages in connection with the use of the information contained herein. Due to data update schedules, the information on this web site may not reflect the most recent changes to property information and tax payments.

← Mobile View

↓ Desktop View

Lancaster County Property Tax Inquiry  Shopping Cart  New Search  County Links

 **LANCASTER COUNTY**  
*Pennsylvania*

Basic Search | Advanced Search

**Parcel Number (Account Number)**

Parcel Number (Account Number)

If you know your parcel/account # use Basic Search  
**TIP - type numbers only**  
 example: 331-52921-0-0000  
 type: 33152921

**Lancaster County Property Tax Inquiry 2027 REASSESSMENT**

NOTE: 2027 REASSESSMENT RECORDS HAVE NAVY HEADINGS  
 CURRENT RECORDS HAVE GREEN HEADINGS

Switch to Advanced Search to search by address

- TIP - type street name only  
 (do not include: street, ave, road, etc)
- if your street name is common: Main, Duke, Hill etc  
 select your municipality to narrow results

Basic Search | **Advanced Search**

**Owner Name**

Owner Name

**Site Criteria**

150

main

120 Conestoga Twp

Select All | Deselect All

- 090 West Cocalico Twp
- 091 West Cocalico Twp
- 100 Colerain Twp
- 110 Columbia Boro
- 120 Conestoga Twp
- 130 Conoy Twp
- 140 Denver Boro
- 150 East Donegal Twp

To search by name enter it here

- TIP - a name search is less likely  
 to return desired results

Basic Search | Advanced Search

**Owner Name**

Bruce Wayne

**Site Criteria**

Click search at the bottom to return results

Search results look like this:

(If there is only one result, the property record will open)

Click on the entry you would like to view - this opens the property record

Property Number	Owner	Address
010-04347-0-0000	ORTH RICHARD C JR,	150 E MAIN ST
010-28805-0-0000	MCSHERRY, KIMBERLY	150 W MAIN ST
210-09425-0-0000	EBERLY, DARRELL	148 E MAIN ST
260-84996-0-0000	BROSSMAN SPRECHER GST TRUST,	150 E MAIN ST
290-65315-0-0000	SNAVELY J C & SONS INC,	150 E MAIN ST
290-66618-0-0000	SNAVELY J C & SONS INC,	150 E MAIN ST
400-96085-0-0000	LESCAVAGE BENJAMIN J,	150 S MAIN ST
470-98796-0-0000	IRWIN, MICHAEL IRWIN, HENRIETTA	150 E MAIN ST
480-61769-0-0000	ANGUS PARK LLC,	150 E MAIN ST
570-76791-0-0000	ROLKO, SETH ROLKO, JULIA NICOLE	150 E MAIN ST

Showing 1 to 10 of 11 entries

To perform a different search  
Click New Search



← Mobile: found in the menu

↓ Desktop: top menu bar

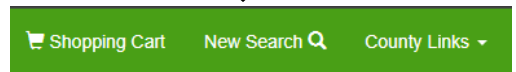

**An example of a residential property record:**

SKETCH: Top view, outside measurements of residence to show changes in story heights (# of floors), basement and porches

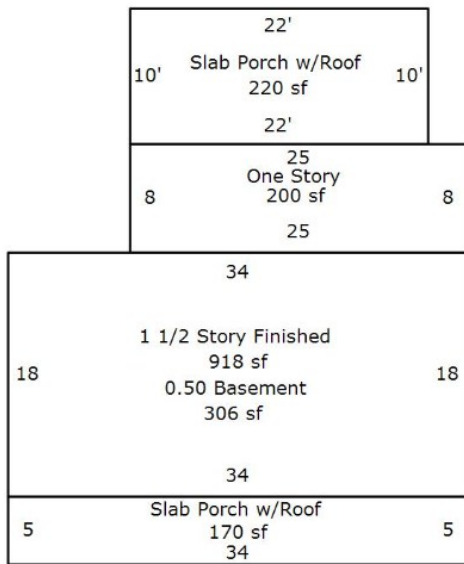

This is Desktop view; Mobile has a slightly different layout with the same information

Structure 1 of 3				
Property Type	Description	Style	Total Living Area	Year Built
RES - Residential	Residence	1 1/2 Story Finished	1,118	1860
<b>Accommodations</b>				
Extra Fixtures		2		
Full Baths		1		
Number of Bedrooms		4		
Number of Families		1		
Number of Rooms		7		
<b>Heating/Cooling</b>				
Add for Oil Fired		1118.00 Sq.Ft.		
Forced Air Furnace		1118.00 Sq.Ft.		
<b>Roofing</b>				
Metal, Preformed		1118.00 Sq.Ft.		
<b>Story Height</b>				
Number of Stories		1.50		
<b>Basement</b>				
Minimal Finish Area		240.00 Sq.Ft.		
Total Basement Area		306.00 Sq.Ft.		
<b>Exterior Walls</b>				
Frame, Siding, Metal		1118.00 Sq.Ft.		
<b>Fuel Type</b>				
Fuel Type		Oil		
<b>Porches, Decks, Breezeways</b>				
Slab Porch with Roof		390.00 Sq.Ft.		
<b>Style</b>				
Style		CONVENTIONAL		

**Lancaster County Property Tax Inquiry 2027 REASSESSMENT**

NOTE: 2027 REASSESSMENT RECORDS HAVE NAVY HEADINGS  
CURRENT RECORDS HAVE GREEN HEADINGS

**DO NOT PAY FOR YOUR PROPERTY RECORD— ASSESSMENT RECORDS ARE FREE PUBLIC INFORMATION**